

19 443 KS0 GROHE ONDUS THERMOSTATIC SHOWER MIXER

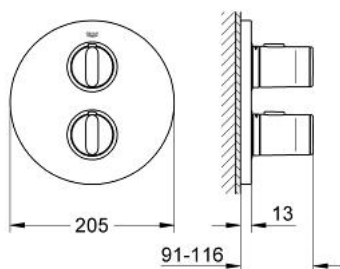

PRODUCT DESCRIPTION

- TMV2 compliant when used with 35 050 000
- set for final installation for
- GROHE Rapido T 35 500 000 / 35 050 000
- without concealed body
- volume handle with GROHE EcoButton (economy button with individually adjustable economy stop)
- temperature scale handle with GROHE SafeStop safety stop at 38°C (calibration required)
- metal handles
- metal escutcheon
- escutcheon- and shaft-sealings
- covered fixing



19 443 KS0 GROHE ONDUS THERMOSTATIC SHOWER MIXER

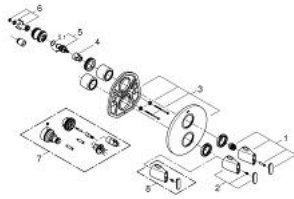

SPARE PARTS, April 2014 – now

- 1: Handle for shut-off valve (Spare part-nr. 47794KS0)
- 2: Scale handle, metallic (Spare part-nr. 47795KS0)
- 3: Escutcheon (Spare part-nr. 47797KS0)
- 4: Temperature limiter (Spare part-nr. 10093000)
- 5: Ceramic headpart, 1/2" (Spare part-nr. 45346000)
- 5.1: O-Ring $\varnothing 18,2 \times \varnothing 1,7$ (Spare part-nr. 0392400M)
- 6: Adapter (Spare part-nr. 12702000)
- 7: Extension set 27.5 mm (Spare part-nr. 47780000)*
- 8: Scale handle, metallic (Spare part-nr. 47798KS0)*

* Optional accessories