

32 401 000 **EUROFRESH SINGLE-LEVER BATH/SHOWER MIXER 1/2"**

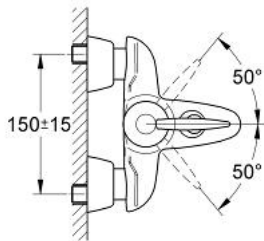

PRODUCT DESCRIPTION

- wall mounted
- GROHE SilkMove 46 mm ceramic cartridge
- adjustable flow rate limiter
- concentric casted spout
- automatic diverter: bath/shower
- mousseur
- integrated non-return valve
- covered S-unions
- covered lever fixing
- protected against backflow
- optional temperature limiter (46 308 000)
- GROHE StarLight chrome finish

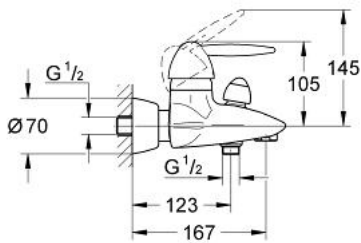

32 401 000 EUROFRESH SINGLE-LEVER BATH/SHOWER MIXER 1/2"

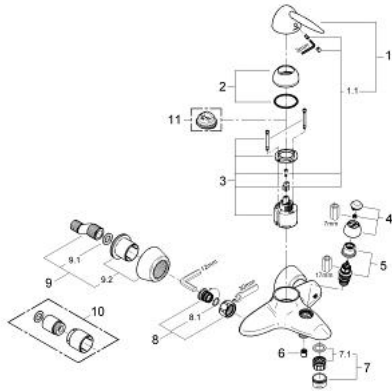

SPARE PARTS, November 2003 – now

- 1: Lever (Spare part-nr. 46545000)
 - 1.1: Replacement handle connection kit (Spare part-nr. 46546000)
 - 2: Shield for cross handle (Spare part-nr. 46417000)
 - 3: Cartridge (Spare part-nr. 46048000)
 - 4: Diverter knob (Spare part-nr. 46547000)
 - 5: Diverter (Spare part-nr. 08915000)
 - 6: Non-return valve (Spare part-nr. 08565000)
 - 7: Flow restrictor (Spare part-nr. 13927000)
 - 7.1: Repl.kit f.aerator M28x1 (Spare part-nr. 45029000)
 - 8: Screw joint (Spare part-nr. 45044000)
 - 8.1: O-Ring Ø15 x Ø2 (Spare part-nr. 0311900M)
 - 9: S-union (Spare part-nr. 12058000)
 - 9.1: Sealing washer (Spare part-nr. 0138600M)
 - 9.2: Covering escutcheon (Spare part-nr. 45545000)
 - 10: Extension 30 (Spare part-nr. 46238000)*
 - 11: Temperature limiter (Spare part-nr. 46308000)*
- * Optional accessories